



**26 Gilwinga Drive BAYVIEW NSW**

6 🏠 4 🚗 2 🚘

This captivating property has a real sense of exclusivity and escape presiding over an exceptional one acre block at the end of a peaceful cul-de-sac.

Hidden from the road, it's the ultimate beaches escape with so much room for the family and kids to enjoy an idyllic lifestyle. Although the feel is seclusion, its mere moments to Mona Vale's bustling village heart, bus services, exceptional public and private schools, Bayview Golf Club, bayside Rowland Reserve, boat ramp, Newport yachting and sailing clubs.

Features the following benefits:

- Move straight in or even rebuild using the recently approved DA plans
- Spacious main living room featuring an open fireplace and bi-folding doors leading to the outdoor entertaining area.
- Gourmet kitchen with an island bench, ample storage and

**View :** <https://www.hunterestateagents.com.au/7586686>



**Duane Hunter**  
**(02) 9970 7220**



SITE PLAN

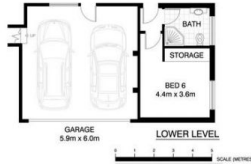

**BAYVIEW**  
**26 GILWINGA DRIVE**  
 \*INTERNAL FLOOR AREA APPROX 283m<sup>2</sup>  
 INCL GARAGE

\*PLANS SHOWN ONLY INDICATIVE OF LAYOUT. DIMENSIONS ARE APPROXIMATE.  
 Floor plan supplied by V Mark Design Pty Ltd. This floor plan is provided for indicative purposes only.  
 Measurements are approximate and not to scale. The vendor, agent and supplier will accept no liability for its accuracy. Interested parties are advised to make their own independent enquiries.